

Machine mounts

standard

Art.Code	L (mm)	Ls (mm)	K (mm)	D (mm)	H (mm)	B (mm)	M (mm)	d (mm)	Shore A
6001603243	168	132	113	150	51,5	168	M16i	12,5	40°
6001603257	168	132	113	150	51,5	168	M16i	12,5	55°
6001603268	168	132	113	150	51,5	168	M16i	12,5	70°

On request this machine mount is optional height adjustable

- L = length
- Ls = spacing mounting holes
- K = diameter lid
- D = diameter
- H = height
- B = width
- M = screw thread
- d = bore diameter
- Shore A = hardness

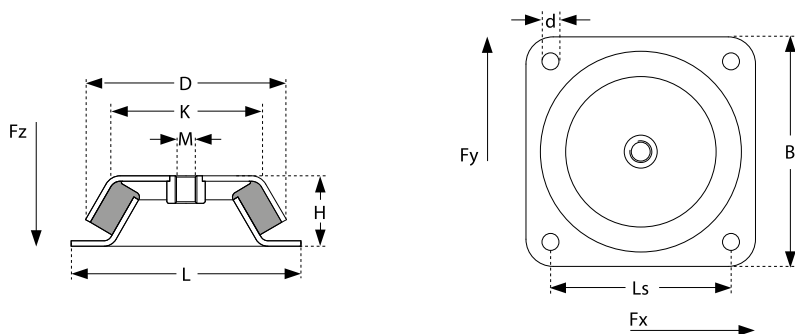

Load Fz

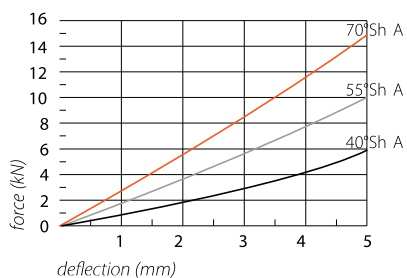

Machine mounts

standard

Art.Code	L (mm)	Ls (mm)	K (mm)	D (mm)	H (mm)	B (mm)	M (mm)	d (mm)	Shore A
6002003443	184	150	126	175	63	184	M20i	13	40°
6002003457	184	150	126	175	63	184	M20i	13	55°
6002003468	184	150	126	175	63	184	M20i	13	70°

On request this machine mount is optional height adjustable

- L = length
- Ls = spacing mounting holes
- K = diameter lid
- D = diameter
- H = height
- B = width
- M = screw thread
- d = bore diameter
- Shore A = hardness

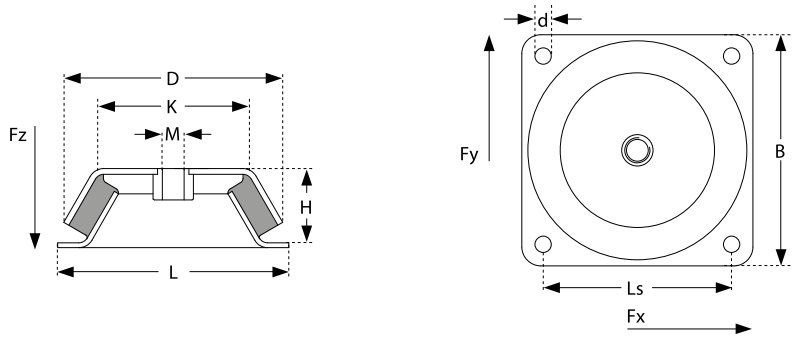

Load Fz

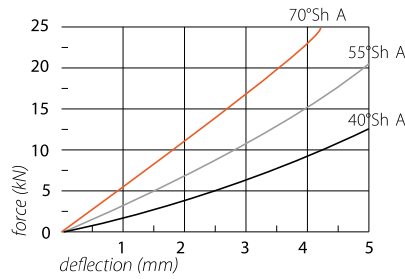

Machine mounts fail safe

standard

Art.Code	L (mm)	Ls (mm)	K (mm)	D (mm)	H (mm)	B (mm)	M (mm)	d (mm)	Shore A
6001640S	168	132	113	150	51,5	168	M16i	13	40°
6001655S	168	132	113	150	51,5	168	M16i	13	55°
6001670S	168	132	113	150	51,5	168	M16i	13	70°

On request this machine mount is optional height adjustable

- L = length
- Ls = spacing mounting holes
- K = diameter lid
- D = diameter
- H = height
- B = width
- M = screw thread
- d = bore diameter
- Shore A = hardness

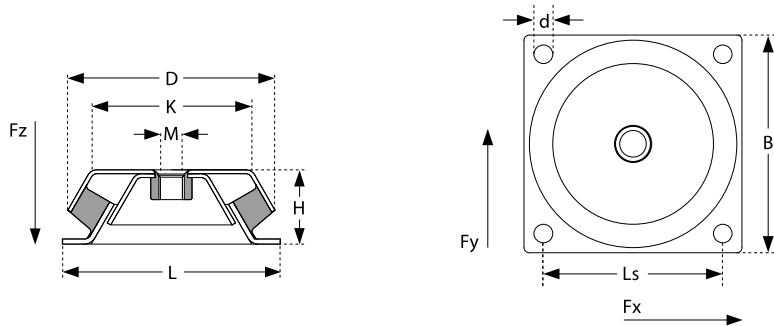

Load Fz

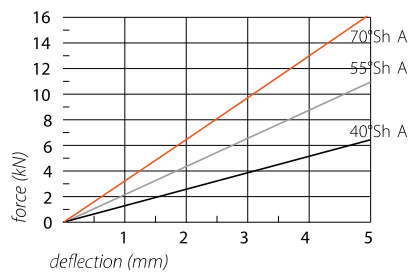

Machine mounts fail safe

standard

Art.Code	L (mm)	Ls (mm)	K (mm)	D (mm)	H (mm)	B (mm)	M (mm)	d (mm)	Shore A
6002043S	184	150	126	175	63	184	M20i	13	40°
6002057S	184	150	126	175	63	184	M20i	13	55°
6002068S	184	150	126	175	63	184	M20i	13	70°

On request this machine mount is optional height adjustable

- L = length
- Ls = spacing mounting holes
- K = diameter lid
- D = diameter
- H = height
- B = width
- M = screw thread
- d = bore diameter
- Shore A = hardness

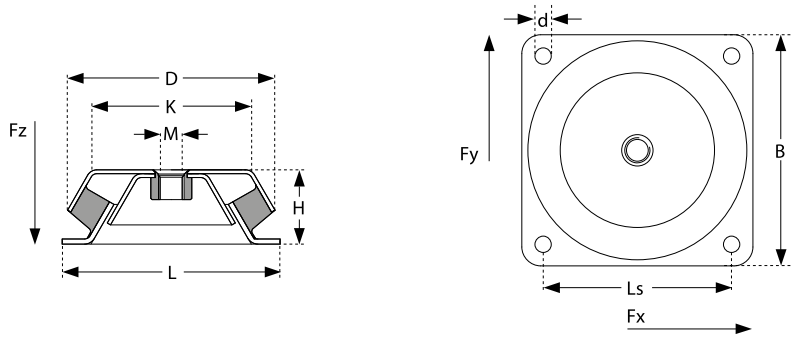

Load Fz

