

Cylindrical dampers

type A/F

Art.Code	D (mm)	H (mm)	M (mm)	L Screw length (mm)
2015AF	20	15	M6	8 10 12 15 18 20
2019AF	20	19		8 10 12 15 18 20
2040AF	20	40		8 10 12 15 18 20
3020AF	30	20	M8	8 10 13 16 18 20 23 27
4028AF	40	28	M10	13 16 23 25 28
5030AF	50	30		15 20 28 33
5744AF	57	44	M8	15 20 28 33
6060AF	60	60	M10	15 20 25 28 33

Column L: standard stock keeping items are printed bold, all other sizes are available on request.

- D = diameter
- H = height
- M = screw thread
- L = screw length

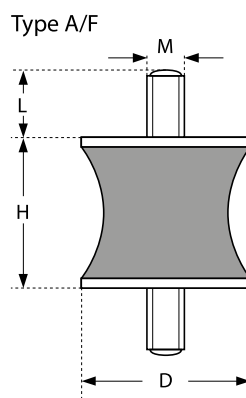

maximal load

D (mm)	H (mm)	M (mm)	L (mm)	type A/F		
				Vb (N)	Hb (N)	Tb (N)
20	15	6	15	250	6	110
20	19	6		200	45	110
20	40	6	12	-	-	500
30	20	8	20	360	80	200
50	30	10	28	1100	250	630

- Vb (N/mm) = Vertical load in N
- Hb (N/mm) = Horizontal load in N
- Tb (N/mm) = Tensile load in N
- Rubber shore hardness 55° Shore A

Version B/F + C/F available on request

- D = diameter
- H = height
- M = screw thread
- G = screw depth
- L = screw length

