

Hoogelastische machinevoeten

incl. afdekschijf

Art.Code	D (mm)	H (mm)	M (mm)	Ls (mm)	d (mm)	L (mm)	S (mm)
EST40	40	20	M6i	52	6,2	65	3
EST60	60	24	M6i	76	6,2	90	3
EST80	80	27	M8i	100	8,2	120	3
EST100	100	28	M10i	124	10,2	148	3
EST150	150	39	M14i	182	12,2	214	4
EST200	200	44	M18i	240	14,5	280	4

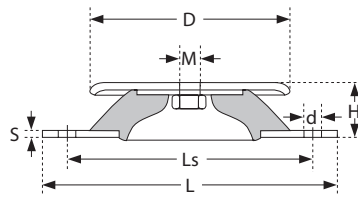

Standaard verkrijgbaar in hardheden 45° shA en 60° shA

EST - 40

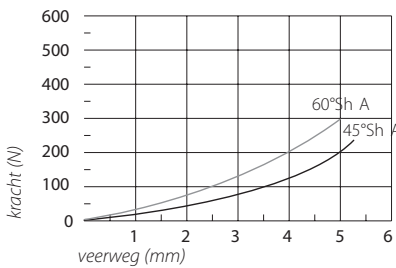

EST - 60

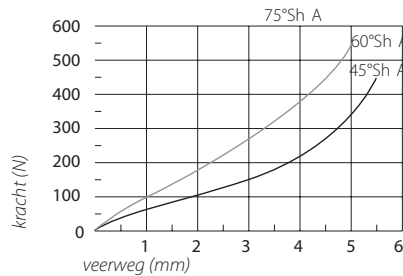

EST - 80

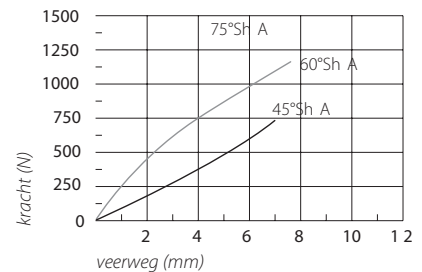

EST - 100

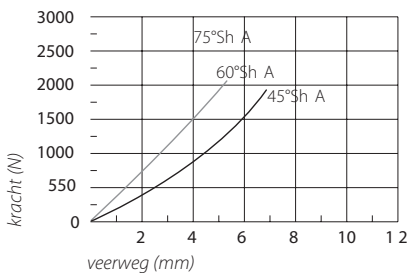

EST - 150

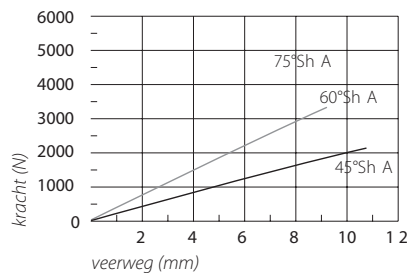

EST - 200

